

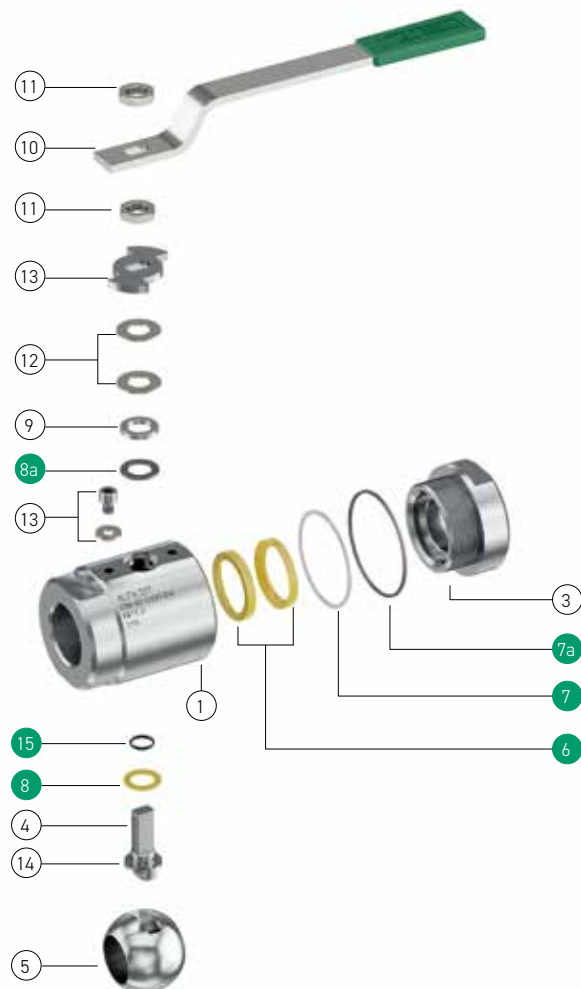

A20T 1500lb screwed body type ball valve - full bore

	PART NAME PARTICOLARE	Q.TY Q.TA'	MATERIALS MATERIALI	
1	body corpo	1	ASTM A105N/LF2	ASTM A479 316/316L
3	closure chiusura	1	ASTM A105N/LF2	ASTM A479 316/316L
4	stem stelo	1	ASTM A182 F51	
5	ball sfera	1	ASTM A351 CF8	ASTM A351 CF8M
6	seats sedi	2	DEVLON	
7	1 st body gasket guarnizione corpo int.	1	P.T.F.E.	
7a	2 nd body gasket guarnizione corpo est.	1	GRAPHOIL	
8	washer bussola	1	DEVLON	
8a	stem gasket guarnizione stelo	1	GRAPHOIL	
9	gland premi-guarnizione	1	Carbon steel Zinc Coated	Stainless Steel 316
10	lever leva	1	Carbon steel Zinc Coated	
11	stem nut dado stelo	2	Cl.8	A4-40 (AISI 316)
12	spring washer molla a tazza	2	51 CrV4 Zinc coated	AISI 316
13	stop device dispositivo di arresto	1	Cl. 8.8 Zinc Coated	AISI 316
14	antistatic device dispositivo antistatico	1	AISI 316	
15	stem o-ring o-ring stelo	1	VITON 90 Sh. A AED	



Spares parts / Parti di ricambio

STANDARD FEATURES CARATTERISTICHE STANDARD

Flange Facing / Finitura Flange : NPT (ASME B1.20.1)-GAS (ISO 228/1)-BW Sch.80 (ASME B16.25)
SW (ASME B16.11)

Face to face / Scartamento : Manufacturer standard

Design according to / Progettazione secondo : ASME B16.34, EN 12516-1, EN 17292, PED 2014/68/UE

Fire Safe Design and Construction according to / Costruzione e assemblaggio Fire Safe secondo :
EN ISO 10497, API 6FA, API 607

Antistatic Device according to / Dispositivo antistatico secondo : BS 5146

Tightness class / Classe di tenuta : VI (FCI 70-2 - ANSI B 16.104)

Stem sealing with O-ring, Anti Blow-out stem / Tenuta stelo con O-Ring, stelo anti-espulsione

A20T 1500lb CARBON STEEL BODY / CORPO ACCIAIO AL CARBONIO

A105N
(LF2)

DN	VALVE RATING	VALVE CODE	DESCRIPTION	VALVE PRICE (€)	KIT CODE	KIT PRICE (€)
06	1500lb	A2T06P4CN-0002-M0090	ALFA20T DN06 1500lb A105N GAS FS		N.A. (*)	
06	1500lb	A2T06P4CN-0001-M0090	ALFA20T DN06 1500lb A105N NPT FS		N.A. (*)	
10	1500lb	A2T10P4CN-0002-M0090	ALFA20T DN10 1500lb A105N GAS FS		N.A. (*)	
10	1500lb	A2T10P4CN-0001-M0090	ALFA20T DN10 1500lb A105N NPT FS		N.A. (*)	
15	1500lb	A2T15P4CN-0002-M0090	ALFA20T DN15 1500lb A105N GAS FS		KGA2T15P4-001	
15	1500lb	A2T15P4CN-0001-M0090	ALFA20T DN15 1500lb A105N NPT FS		KGA2T15P4-001	
15	1500lb	A2T15P4CN-0002-M0010	ALFA20T DN15 1500lb A105N BW FS		KGA2T15P4-001	
15	1500lb	A2T15P4CN-0001-M0010	ALFA20T DN15 1500lb A105N SW FS		KGA2T15P4-001	
20	1500lb	A2T20P4CN-0002-M0090	ALFA20T DN20 1500lb A105N GAS FS		KGA2T20P4-001	
20	1500lb	A2T20P4CN-0001-M0090	ALFA20T DN20 1500lb A105N NPT FS		KGA2T20P4-001	
20	1500lb	A2T20P4CN-0002-M0010	ALFA20T DN20 1500lb A105N BW FS		KGA2T20P4-001	
20	1500lb	A2T20P4CN-0001-M0010	ALFA20T DN20 1500lb A105N SW FS		KGA2T20P4-001	
25	1500lb	A2T25P4CN-0002-M0090	ALFA20T DN25 1500lb A105N GAS FS		KGA2T25P4-001	
25	1500lb	A2T25P4CN-0001-M0090	ALFA20T DN25 1500lb A105N NPT FS		KGA2T25P4-001	
25	1500lb	A2T25P4CN-0002-M0010	ALFA20T DN25 1500lb A105N BW FS		KGA2T25P4-001	
25	1500lb	A2T25P4CN-0001-M0010	ALFA20T DN25 1500lb A105N SW FS		KGA2T25P4-001	
32	1500lb	A2T32P4CN-0002-M0090	ALFA20T DN32 1500lb A105N GAS FS		KGA2T32P4-001	
32	1500lb	A2T32P4CN-0001-M0090	ALFA20T DN32 1500lb A105N NPT FS		KGA2T32P4-001	
40	1500lb	A2T40P4CN-0002-M0090	ALFA20T DN40 1500lb A105N GAS FS		KGA2T40P4-001	
40	1500lb	A2T40P4CN-0001-M0090	ALFA20T DN40 1500lb A105N NPT FS		KGA2T40P4-001	
40	1500lb	A2T40P4CN-0002-M0010	ALFA20T DN40 1500lb A105N BW FS		KGA2T40P4-001	
40	1500lb	A2T40P4CN-0001-M0010	ALFA20T DN40 1500lb A105N SW FS		KGA2T40P4-001	
50	1500lb	A2T50P4CN-0002-M0090	ALFA20T DN50 1500lb A105N GAS FS		KGA2T50P4-001	
50	1500lb	A2T50P4CN-0001-M0090	ALFA20T DN50 1500lb A105N NPT FS		KGA2T50P4-001	

(*) FOR VALVES DN06/DN10 SPARE PARTS KIT WILL NOT BE AVAILABLE - I KIT DI RICAMBIO NON SONO DISPONIBILI PER VALVOLE DN06/10

A20T 1500lb STAINLESS STEEL BODY / CORPO ACCIAIO INOSSIDABILE

316(L)

DN	VALVE RATING	VALVE CODE	DESCRIPTION	VALVE PRICE (€)	KIT CODE	KIT PRICE (€)
06	1500lb	A2T06P4SD-0002-M0000	ALFA20T DN06 1500lb 316/316L GAS FS		N.A. (*)	
06	1500lb	A2T06P4SD-0001-M0000	ALFA20T DN06 1500lb 316/316L NPT FS		N.A. (*)	
10	1500lb	A2T10P4SD-0002-M0000	ALFA20T DN10 1500lb 316/316L GAS FS		N.A. (*)	
10	1500lb	A2T10P4SD-0001-M0000	ALFA20T DN10 1500lb 316/316L NPT FS		N.A. (*)	
15	1500lb	A2T15P4SD-0002-M0000	ALFA20T DN15 1500lb 316/316L GAS FS		KGA2T15P4-001	
15	1500lb	A2T15P4SD-0001-M0000	ALFA20T DN15 1500lb 316/316L NPT FS		KGA2T15P4-001	
15	1500lb	A2T15P4SD-0004-M0000	ALFA20T DN15 1500lb 316/316L BW FS		KGA2T15P4-001	
15	1500lb	A2T15P4SD-0003-M0000	ALFA20T DN15 1500lb 316/316L SW FS		KGA2T15P4-001	
20	1500lb	A2T20P4SD-0002-M0000	ALFA20T DN20 1500lb 316/316L GAS FS		KGA2T20P4-001	
20	1500lb	A2T20P4SD-0001-M0000	ALFA20T DN20 1500lb 316/316L NPT FS		KGA2T20P4-001	
20	1500lb	A2T20P4SD-0004-M0000	ALFA20T DN20 1500lb b 316/316L BW FS		KGA2T20P4-001	
20	1500lb	A2T20P4SD-0003-M0000	ALFA20T DN20 1500lb 316/316L SW FS		KGA2T20P4-001	
25	1500lb	A2T25P4SD-0002-M0000	ALFA20T DN25 1500lb 316/316L GAS FS		KGA2T25P4-001	
25	1500lb	A2T25P4SD-0001-M0000	ALFA20T DN25 1500lb 316/316L NPT FS		KGA2T25P4-001	
25	1500lb	A2T25P4SD-0004-M0000	ALFA20T DN25 1500lb 316/316L BW FS		KGA2T25P4-001	
25	1500lb	A2T25P4SD-0003-M0000	ALFA20T DN25 1500lb 316/316L SW FS		KGA2T25P4-001	
40	1500lb	A2T40P4SD-0002-M0000	ALFA20T DN40 1500lb 316/316L GAS FS		KGA2T40P4-001	
40	1500lb	A2T40P4SD-0001-M0000	ALFA20T DN40 1500lb 316/316L NPT FS		KGA2T40P4-001	
40	1500lb	A2T40P4SD-0004-M0000	ALFA20T DN40 1500lb 316/316L BW FS		KGA2T40P4-001	
40	1500lb	A2T40P4SD-0003-M0000	ALFA20T DN40 1500lb 316/316L SW FS		KGA2T40P4-001	
50	1500lb	A2T50P4SD-0002-M0000	ALFA20T DN50 1500lb 316/316L GAS FS		KGA2T50P4-001	
50	1500lb	A2T50P4SD-0001-M0000	ALFA20T DN50 1500lb 316/316L NPT FS		KGA2T50P4-001	
50	1500lb	A2T50P4SD-0004-M0000	ALFA20T DN50 1500lb 316/316L BW FS		KGA2T50P4-001	
50	1500lb	A2T50P4SD-0003-M0000	ALFA20T DN50 1500lb 316/316L SW FS		KGA2T50P4-001	

(*) FOR VALVES DN06/DN10 SPARE PARTS KIT WILL NOT BE AVAILABLE - I KIT DI RICAMBIO NON SONO DISPONIBILI PER VALVOLE DN06/10



Product codes in bold are related to product available on stock; delivery time within 3 weeks based on ordered quantity.

All other codes are related to product ready for assembly; delivery time within 5 weeks based on ordered quantity.

Missing Sizes and Special Executions are available upon request. Please contact Sales Dept. for availability and delivery time

I codici in grassetto indicano prodotti normalmente disponibili a stock; consegna entro 3 settimane secondo quantità ordinate

Gli altri codici indicano prodotti disponibili per assemblaggio; consegna entro 5 settimane secondo quantità ordinate

Dimensioni mancanti ed esecuzioni speciali sono disponibili su richiesta. Si prega contattare Ufficio commerciale per disponibilità e consegne