

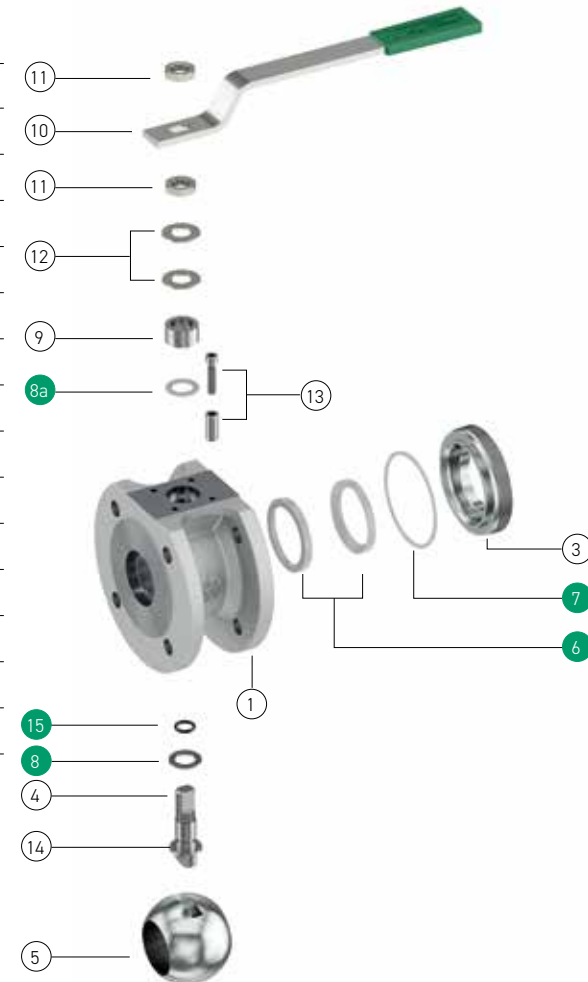

# A10NF PN10-40 wafer type ball valve

INVESTMENT CASTING BODY  
CORPO DA FUSIONE

PART NAME PARTICOLARE	Q.TY Q.TA'	MATERIALS MATERIALI			
1 body corpo	1	ASTM A216 WCB	ASTM A351 CF8M	ASTM A351 CF8	
3 closure chiusura	1	ASTM A216 WCB	ASTM A351 CF8M	ASTM A351 CF8	
4 stem stelo	1	ASTM A479 F6a (AISI 410)	ASTM A182 316/316L		
5 ball sfera	1	ASTM A351 CF8	ASTM A351 CF8M	ASTM A351 CF8	
6 seats sedi	2	TFM	TFM		
7 body gasket guarnizione corpo	1	P.T.F.E./GRAPHOIL (DN>100)	P.T.F.E./GRAPHOIL (DN> 100)		
8 washer bussola	1	P.T.F.E.	P.T.F.E.		
8a stem gasket guarnizione stelo	1	GRAPHOIL	GRAPHOIL		
9 gland preguarnizione	1	Carbon Steel Zinc Coated	Stainless Steel 316		
10 lever leva	1	Carbon Steel Zinc Coated	Carbon Steel Zinc Coated		
11 stem nut dado stelo	2	Cl. 8	A4-40 (AISI 316)		
12 spring washer molla a tazza	2	51CrV4 Zinc Coated	AISI 316		
13 stop device dispositivo di arresto	1	Cl. 8.8 Zinc Coated	AISI 316		
14 antistatic device dispositivo antistatico	2	AISI 316	AISI 316		
15 stem o-ring o-ring stelo	1	VITON 75 Sh. A	VITON 75 Sh. A		
16 body o-ring (DN >100) o-ring corpo	1	P.T.F.E.	P.T.F.E.		



Spares parts / Parti di ricambio

## STANDARD FEATURES CARATTERISTICHE STANDARD

- Flange Facing RF according / Finitura Flange RF according : EN 1092-1
- Flange drilling, metric holes according / Foratura flange, fori metrici secondo : EN1092-1, PN16
- Face to face / Scartamento : EN 558-1
- Design according to / Progettazione secondo : ASME B16.34, EN 12516-1, PED 2014/68/UE
- Fire Safe Design and Construction according to / Costruzione e assemblaggio Fire Safe secondo : EN ISO 10497, API 6FA, API 607
- Antistatic Device according to / Dispositivo antistatico secondo : BS 5146
- Tightness class / Classe di tenuta : VI (FCI 70-2 - ANSI B 16.104)
- Stem sealing with O-ring, Anti Blow-out stem / Tenuta stelo con O-Ring, stelo anti-espulsione
- Actuator coupling flange according to/ Flangia integrata per montaggio comando secondo : ISO 5211

## A10NF PN10-40 CARBON STEEL BODY / CORPO ACCIAIO AL CARBONIO

WCB

DN	VALVE RATING	VALVE CODE	DESCRIPTION	VALVE PRICE (€)	KIT CODE	KIT PRICE (€)
15	PN 10-40	<b>A1N15U4C1-0002-M0010</b>	<b>ALFA10NF DN15 PN10-40 WCB FS RF MET</b>		<b>KGA1N15A1-001</b>	
20	PN 10-40	<b>A1N20U4C1-0002-M0010</b>	<b>ALFA10NF DN20 PN10-40 WCB FS RF MET</b>		<b>KGA1N20A1-001</b>	
25	PN 10-40	<b>A1N25U4C1-0002-M0010</b>	<b>ALFA10NF DN25 PN10-40 WCB FS RF MET</b>		<b>KGA1N25A1-001</b>	
32	PN 10-40	<b>A1N32U4C1-0002-M0010</b>	<b>ALFA10NF DN32 PN10-40 WCB FS RF MET</b>		<b>KGA1N32A1-001</b>	
40	PN 10-40	<b>A1N40U4C1-0002-M0010</b>	<b>ALFA10NF DN40 PN10-40 WCB FS RF MET</b>		<b>KGA1N40A1-001</b>	
50	PN 10-40	<b>A1N50U4C1-0002-M0010</b>	<b>ALFA10NF DN50 PN10-40 WCB FS RF MET</b>		<b>KGA1N50A1-001</b>	
65	PN 10-16	<b>A1N65U3C1-0001-M0010</b>	<b>ALFA10NF DN65 PN10-16 WCB FS RF MET</b>		<b>KGA1N65A1-001</b>	
80	PN 16-40	<b>A1N80U6C1-0002-M0010</b>	<b>ALFA10NF DN80 PN16-40 WCB FS RF MET</b>		<b>KGA1N80A1-001</b>	
100	PN 10-16	<b>A1NA0U3C1-0001-M0010</b>	<b>ALFA10NF DN100 PN10-16 WCB FS RF MET</b>		<b>KGA1NA0A1-002</b>	
125	PN 10-16	A1NA2U3C1-0002-M0010	ALFA10NF DN125 PN10-16 WCB FS RF MET		KGA64A2A1-002	
150	PN 10-16	A1NA5U3C1-0001-M0010	ALFA10NF DN150 PN10-16 WCB FS RF MET		KGA64A5A1-001	
200	PN16	A1NB0U5C1-0001-M0010	ALFA10NF DN200 PN16 WCB FS RF MET		KGA64B0A1-001	

## A10NF PN10-40 STAINLESS STEEL BODY / CORPO ACCIAIO INOSSIDABILE

CF8M

DN	VALVE RATING	VALVE CODE	DESCRIPTION	VALVE PRICE (€)	KIT CODE	KIT PRICE (€)
15	PN 10-40	<b>A1N15U4S2-0001-M0000</b>	<b>ALFA10NF DN15 PN10-40 CF8M FS RF MET</b>		<b>KGA1N15A1-001</b>	
20	PN 10-40	<b>A1N20U4S2-0001-M0000</b>	<b>ALFA10NF DN20 PN10-40 CF8M FS RF MET</b>		<b>KGA1N20A1-001</b>	
25	PN 10-40	<b>A1N25U4S2-0001-M0000</b>	<b>ALFA10NF DN25 PN10-40 CF8M FS RF MET</b>		<b>KGA1N25A1-001</b>	
32	PN 10-40	<b>A1N32U4S2-0001-M0000</b>	<b>ALFA10NF DN32 PN10-40 CF8M FS RF MET</b>		<b>KGA1N32A1-001</b>	
40	PN 10-40	<b>A1N40U4S2-0001-M0000</b>	<b>ALFA10NF DN40 PN10-40 CF8M FS RF MET</b>		<b>KGA1N40A1-001</b>	
50	PN 10-40	<b>A1N50U4S2-0001-M0000</b>	<b>ALFA10NF DN50 PN10-40 CF8M FS RF MET</b>		<b>KGA1N50A1-001</b>	
65	PN 10-16	<b>A1N65U3S2-0001-M0000</b>	<b>ALFA10NF DN65 PN10-16 CF8M FS RF MET</b>		<b>KGA1N65A1-001</b>	
80	PN 16-40	<b>A1N80U6S2-0001-M0000</b>	<b>ALFA10NF DN80 PN16-40 CF8M FS RF MET</b>		<b>KGA1N80A1-001</b>	
100	PN 10-16	<b>A1NA0U3S2-0001-M0000</b>	<b>ALFA10NF DN100 PN10-16 CF8M FS RF MET</b>		<b>KGA1NA0A1-002</b>	
125	PN 10-16	A1NA2U3S2-0002-M0000	ALFA10NF DN125 PN10-16 CF8M FS RF MET		KGA64A2A1-002	
150	PN 10-16	A1NA5U3S2-0001-M0000	ALFA10NF DN150 PN10-16 CF8M FS RF MET		KGA64A5A1-001	
200	PN16	A1NB0U5S2-0001-M0000	ALFA10NF DN200 PN16 CF8M FS RF MET		KGA64B0A1-001	

CF8

DN	VALVE RATING	VALVE CODE	DESCRIPTION	VALVE PRICE (€)	KIT CODE	KIT PRICE (€)
15	PN 10-40	<b>A1N15U4S3-0001-M0000</b>	<b>ALFA10NF DN15 PN10-40 CF8 FS RF MET</b>		<b>KGA1N15A1-001</b>	
20	PN 10-40	<b>A1N20U4S3-0001-M0000</b>	<b>ALFA10NF DN20 PN10-40 CF8 FS RF MET</b>		<b>KGA1N20A1-001</b>	
25	PN 10-40	<b>A1N25U4S3-0001-M0000</b>	<b>ALFA10NF DN25 PN10-40 CF8 FS RF MET</b>		<b>KGA1N25A1-001</b>	
32	PN 10-40	<b>A1N32U4S3-0001-M0000</b>	<b>ALFA10NF DN32 PN10-40 CF8 FS RF MET</b>		<b>KGA1N32A1-001</b>	
40	PN 10-40	<b>A1N40U4S3-0001-M0000</b>	<b>ALFA10NF DN40 PN10-40 CF8 FS RF MET</b>		<b>KGA1N40A1-001</b>	
50	PN 10-40	<b>A1N50U4S3-0001-M0000</b>	<b>ALFA10NF DN50 PN10-40 CF8 FS RF MET</b>		<b>KGA1N50A1-001</b>	
65	PN 10-16	<b>A1N65U3S3-0001-M0000</b>	<b>ALFA10NF DN65 PN10-16 CF8 FS RF MET</b>		<b>KGA1N65A1-001</b>	
80	PN 16-40	<b>A1N80U6S3-0001-M0000</b>	<b>ALFA10NF DN80 PN16-40 CF8 FS RF MET</b>		<b>KGA1N80A1-001</b>	
100	PN 10-16	<b>A1NA0U3S3-0001-M0000</b>	<b>ALFA10NF DN100 PN10-16 CF8 FS RF MET</b>		<b>KGA1NA0A1-002</b>	
150	PN 10-16	A1NA5U3S3-0001-M0000	ALFA10NF DN150 PN10-16 CF8 FS RF MET		KGA64A5A1-001	



Product codes in bold are related to product available on stock; delivery time within 3 weeks based on ordered quantity.  
All other codes are related to product ready for assembly; delivery time within 5 weeks based on ordered quantity.  
Missing Sizes and Special Executions are available upon request. Please contact Sales Dept. for availability and delivery time.  
**I codici in grassetto indicano prodotti normalmente disponibili a stock; consegna entro 3 settimane secondo quantità ordinate.**  
Gli altri codici indicano prodotti disponibili per assemblaggio; consegna entro 5 settimane secondo quantità ordinate.  
Dimensioni mancanti ed esecuzioni speciali sono disponibili su richiesta. Si prega di contattare Ufficio commerciale per disponibilità e consegne.