

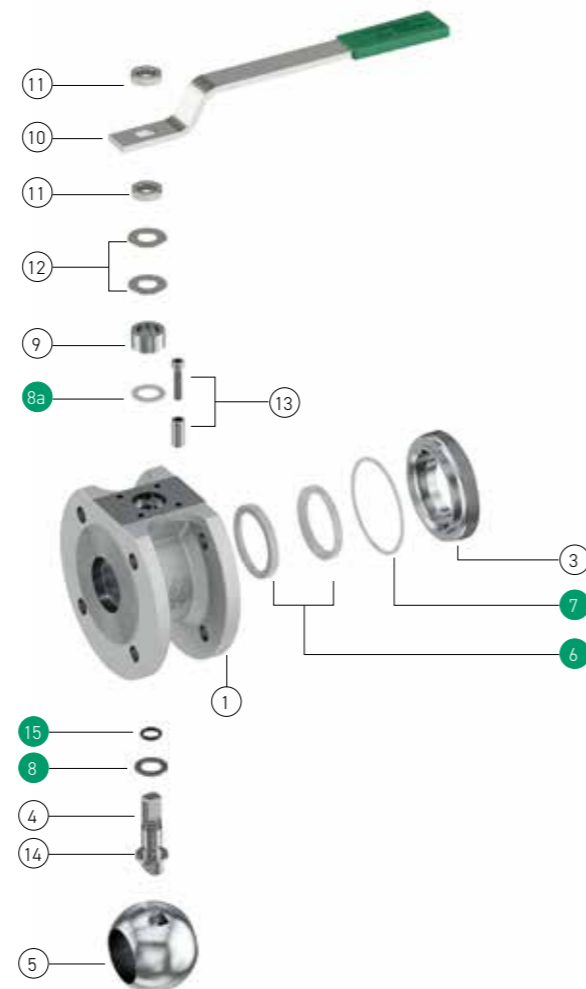

A10NF ANSI 150 wafer type ball valve

INVESTMENT CASTING BODY
CORPO DA FUSIONE

PART NAME PARTICOLARE	Q.TY Q.TA	MATERIALS MATERIALI			
1 body corpo	1	ASTM A216 WCB	ASTM A351 CF8M	ASTM A351 CF8	
3 closure chiusura	1	ASTM A216 WCB	ASTM A351 CF8M	ASTM A351 CF8	
4 stem stelo	1	ASTM A479 F6a (AISI 410)	ASTM A182 316/316L		
5 ball sfera	1	ASTM A351 CF8	ASTM A351 CF8M	ASTM A351 CF8	
6 seats sedi	2	TFM	TFM		
7 body gasket guarnizione corpo	1	P.T.F.E./GRAPHOIL (DN > 100)	P.T.F.E./GRAPHOIL (DN > 100)		
8 washer bussola	1	P.T.F.E.	P.T.F.E.		
8a stem gasket guarnizione stelo	1	GRAPHOIL	GRAPHOIL		
9 gland premigarnizione	1	Carbon Steel Zinc Coated	Stainless Steel 316		
10 lever leva	1	Carbon Steel Zinc Coated	Carbon Steel Zinc Coated		
11 stem nut dado stelo	2	Cl. 8	A4-40 (AISI 316)		
12 spring washer molla a tazza	2	51CrV4 Zinc Coated	AISI 316		
13 stop device dispositivo di arresto	1	Cl. 8.8 Zinc Coated	AISI 316		
14 antistatic device dispositivo antistatico	2	AISI 316	AISI 316		
15 stem o-ring o-ring stelo	1	VITON 75 Sh. A	VITON 75 Sh. A		
16 body o-ring (DN > 100) o-ring corpo	1	P.T.F.E.	P.T.F.E.		



Spares parts / Parti di ricambio

STANDARD FEATURES CARATTERISTICHE STANDARD

Flange Facing RF according / Finitura Flange RF secondo : ASME B16.5, ANSI 150
Flange drilling, metric holes according / Foratura flange, fori metrici secondo : ASME B16.5, ANSI 150
Face to face / Scartamento : EN 558-1
Design according to / Progettazione secondo : ASME B16.34, EN 12516-1, PED 2014/68/UE
Fire Safe Design and Construction according to / Costruzione e assemblaggio Fire Safe secondo : EN ISO 10497, API 6FA, API 607
Antistatic Device according to / Dispositivo antistatico secondo : BS 5146
Tightness class / Classe di tenuta : VI (FCI 70-2 - ANSI B 16.104)
Stem sealing with O-ring, Anti Blow-out stem / Tenuta stelo con O-Ring, stelo anti -espulsione
Actuator coupling flange according to / Flangia integrata per montaggio comando secondo : ISO 5211

A10NF ANSI 150 CARBON STEEL BODY / CORPO ACCIAIO AL CARBONIO

DN	VALVE RATING	VALVE CODE	DESCRIPTION	VALVE PRICE (€)	KIT CODE	KIT PRICE (€)
15	ANSI 150	A1N15A1C1-0002-M0010	ALFA10NF DN15 ANSI150 WCB FS RF MET		KGA1N15A1-001	
20	ANSI 150	A1N20A1C1-0002-M0010	ALFA10NF DN20 ANSI150 WCB FS RF MET		KGA1N20A1-001	
25	ANSI 150	A1N25A1C1-0002-M0010	ALFA10NF DN25 ANSI150 WCB FS RF MET		KGA1N25A1-001	
32	ANSI 150	A1N32A1C1-0002-M0010	ALFA10NF DN32 ANSI150 WCB FS RF MET		KGA1N32A1-001	
40	ANSI 150	A1N40A1C1-0002-M0010	ALFA10NF DN40 ANSI150 WCB FS RF MET		KGA1N40A1-001	
50	ANSI 150	A1N50A1C1-0002-M0010	ALFA10NF DN50 ANSI150 WCB FS RF MET		KGA1N50A1-001	
65	ANSI 150	A1N65A1C1-0002-M0010	ALFA10NF DN65 ANSI150 WCB FS RF MET		KGA1N65A1-001	
80	ANSI 150	A1N80A1C1-0002-M0010	ALFA10NF DN80 ANSI150 WCB FS RF MET		KGA1N80A1-001	
100	ANSI 150	A1NA0A1C1-0001-M0010	ALFA10NF DN100 ANSI150 WCB FS RF MET		KGA1NA0A1-002	
125	ANSI 150	A1NA2A1C1-0001-M0010	ALFA10NF DN125 ANSI150 WCB FS RF MET		KGA64A2A1-002	
150	ANSI 150	A1NA5A1C1-0001-M0010	ALFA10NF DN150 ANSI150 WCB FS RF MET		KGA64A5A1-001	
200	ANSI 150	A1NB0A1C1-0001-M0010	ALFA10NF DN200 ANSI150 WCB FS RF MET		KGA64B0A1-001	

A10NF ANSI 150 STAINLESS STEEL BODY / CORPO ACCIAIO INOSSIDABILE

DN	VALVE RATING	VALVE CODE	DESCRIPTION	VALVE PRICE (€)	KIT CODE	KIT PRICE (€)
15	ANSI 150	A1N15A1S2-0001-M0000	ALFA10NF DN15 ANSI150 CF8M FS RF MET		KGA1N15A1-001	
20	ANSI 150	A1N20A1S2-0001-M0000	ALFA10NF DN20 ANSI150 CF8M FS RF MET		KGA1N20A1-001	
25	ANSI 150	A1N25A1S2-0001-M0000	ALFA10NF DN25 ANSI150 CF8M FS RF MET		KGA1N25A1-001	
32	ANSI 150	A1N32A1S2-0001-M0000	ALFA10NF DN32 ANSI150 CF8M FS RF MET		KGA1N32A1-001	
40	ANSI 150	A1N40A1S2-0001-M0000	ALFA10NF DN40 ANSI150 CF8M FS RF MET		KGA1N40A1-001	
50	ANSI 150	A1N50A1S2-0001-M0000	ALFA10NF DN50 ANSI150 CF8M FS RF MET		KGA1N50A1-001	
65	ANSI 150	A1N65A1S2-0001-M0000	ALFA10NF DN65 ANSI150 CF8M FS RF MET		KGA1N65A1-001	
80	ANSI 150	A1N80A1S2-0001-M0000	ALFA10NF DN80 ANSI150 CF8M FS RF MET		KGA1N80A1-001	
100	ANSI 150	A1NA0A1S2-0001-M0000	ALFA10NF DN100 ANSI150 CF8M FS RF MET		KGA1NA0A1-002	
125	ANSI 150	A1NA2A1S2-0001-M0000	ALFA10NF DN125 ANSI150 CF8M FS RF MET		KGA64A2A1-002	
150	ANSI 150	A1NA5A1S2-0001-M0000	ALFA10NF DN150 ANSI150 CF8M FS RF MET		KGA64A5A1-001	
200	ANSI 150	A1NB0A1S2-0001-M0000	ALFA10NF DN200 ANSI150 CF8M FS RF MET		KGA64B0A1-001	

DN	VALVE RATING	VALVE CODE	DESCRIPTION	VALVE PRICE (€)	KIT CODE	KIT PRICE (€)
15	ANSI 150	A1N15A1S3-0001-M0000	ALFA10NF DN15 ANSI150 CF8 FS RF MET		KGA1N15A1-001	
20	ANSI 150	A1N20A1S3-0001-M0000	ALFA10NF DN20 ANSI150 CF8 FS RF MET		KGA1N20A1-001	
25	ANSI 150	A1N25A1S3-0001-M0000	ALFA10NF DN25 ANSI150 CF8 FS RF MET		KGA1N25A1-001	
32	ANSI 150	A1N32A1S3-0001-M0000	ALFA10NF DN32 ANSI150 CF8 FS RF MET		KGA1N32A1-001	
40	ANSI 150	A1N40A1S3-0001-M0000	ALFA10NF DN40 ANSI150 CF8 FS RF MET		KGA1N40A1-001	
50	ANSI 150	A1N50A1S3-0001-M0000	ALFA10NF DN50 ANSI150 CF8 FS RF MET		KGA1N50A1-001	
65	ANSI 150	A1N65A1S3-0001-M0000	ALFA10NF DN65 ANSI150 CF8 FS RF MET		KGA1N65A1-001	
80	ANSI 150	A1N80A1S3-0001-M0000	ALFA10NF DN80 ANSI150 CF8 FS RF MET		KGA1N80A1-001	
100	ANSI 150	A1NA0A1S3-0001-M0000	ALFA10NF DN100 ANSI150 CF8 FS RF MET		KGA1NA0A1-002	
150	ANSI 150	A1NA5A1S3-0001-M0000	ALFA10NF DN150 ANSI150 CF8 FS RF MET		KGA64A5A1-001	



Product codes in bold are related to product available on stock; delivery time within 3 weeks based on ordered quantity.

All other codes are related to product ready for assembly; delivery time within 5 weeks based on ordered quantity.

Missing Sizes and Special Executions are available upon request. Please contact Sales Dept. for availability and delivery time

I codici in grassetto indicano prodotti normalmente disponibili a stock; consegna entro 3 settimane secondo quantità ordinate

Gli altri codici indicano prodotti disponibili per assemblaggio; consegna entro 5 settimane secondo quantità ordinate

Dimensioni mancanti ed esecuzioni speciali sono disponibili su richiesta. Si prega contattare Ufficio commerciale per disponibilità e consegne