



# A60 ANSI 300 flanged type ball valve, full bore

INVESTMENT CASTING BODY  
CORPO DA FUSIONE

PART NAME PARTICOLARE	Q.TY Q.TA'	MATERIALS MATERIALI	
1 body corpo	1	ASTM A216 WCB	ASTM A351 CF8M
2 stud tirante	4/8	ASTM A193 B7	ASTM A193 B8M
2b nut dado	4/8	ASTM A194 2H	ASTM A194 B8
3 closure chiusura	1	ASTM A216 WCB	ASTM A351 CF8M
4 stem stelo	1	ASTM A479 F6a (AISI 410)	ASTM A182 316/316L
5 ball sfera	1	ASTM A351 CF8	ASTM A351 CF8M
6 seats sedi	2	TFM / PTFE + A.M. (DN 150)	
7 1 <sup>st</sup> body gasket guarnizione corpo int.	1	P.T.F.E. (DN < 80)	
7a 2 <sup>nd</sup> body gasket guarnizione corpo est.	1	GRAPHOIL	
8 washer bussola	1	P.T.F.E.	
8a stem gasket guarnizione stelo	1	GRAPHOIL	
9 gland preguarnizione	1	Carbon Steel Zinc Coated	Stainless Steel 316
10 lever leva	1	Carbon Steel Zinc Coated	
11 stem nut dado stelo	2	Cl. 8	A4-40 (AISI 316)
12 spring washer molla a tazza	2	51CrV4 Zinc Coated	AISI 316
13 stop device dispositivo di arresto	1	Cl. 8.8 Zinc Coated	AISI 316
14 antistatic device dispositivo antistatico	2	AISI 316	
15 stem O-ring O-ring stelo	1	VITON 75 Sh. A	
16 body O-ring O-ring corpo	1	P.T.F.E. (DN > 100)	

Spares parts / Parti di ricambio

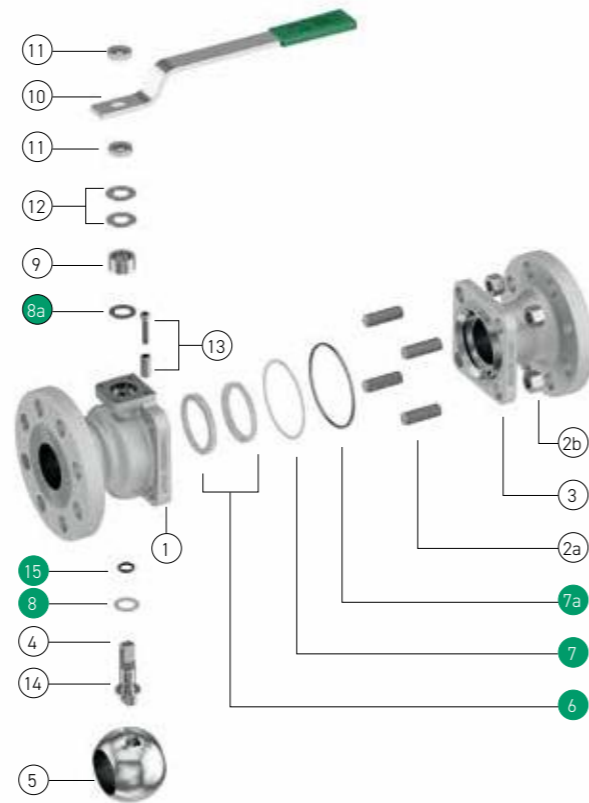

## STANDARD FEATURES CARATTERISTICHE STANDARD

Flange Facing RF according to / Finitura Flange RF secondo : ASME B16.5, ANSI 300
Flange drilling, smooth holes according / Foratura flange, fori lisci secondo : ASME B16.5, ANSI 300
Face to face / Scartamento : ASME B 16.10, ANSI 300
Design according to/ Progettazione secondo : ASME B16.34, EN 12516-1, PED 2014/68/UE
Fire Safe Design and Construction according to / Costruzione e assemblaggio Fire Safe secondo : EN ISO 10497, API 6FA, API 607
Antistatic Device according to / dispositivo antistatico secondo : BS 5146
Tightness class / Classe di tenuta : VI (FCI 70-2 - ANSI B 16.104)
Stem sealing with O-ring, Anti Blow-out stem / Tenuta stelo con O-Ring, stelo anti-espulsione
Actuator coupling flange according to / Flangia integrata per montaggio comando secondo : ISO 5211

## A60 ANSI300 CARBON STEEL BODY / CORPO ACCIAIO AL CARBONIO

DN	VALVE RATING	VALVE CODE	DESCRIPTION	VALVE PRICE (€)	KIT CODE	KIT PRICE (€)
15	ANSI 300	A6015A2C1-0002-M0010	ALFA60 DN15 ANSI300 WCB FS RF		KGA6415A1-001	
25	ANSI 300	A6025A2C1-0001-M0010	ALFA60 DN25 ANSI300 WCB FS RF		KGA6425A1-001	
50	ANSI 300	A6050A2C1-0001-M0010	ALFA60 DN50 ANSI300 WCB FS RF		KGA6450A1-001	
80	ANSI 300	A6080A2C1-0001-M0010	ALFA60 DN80 ANSI300 WCB FS RF		KGA6480A1-001	
100	ANSI 300	A60A0A2C1-0001-M0010	ALFA60 DN100 ANSI300 WCB FS RF		KGA64A0A1-002	
150	ANSI 300	A60A5A2C1-0001-K0010	ALFA60 DN150 ANSI300 WCB FS RF		KGA64A5A1-002	

WCB

(\*) BARE STEM VALVE- VALVOLA A STELO NUDO

## A60 ANSI300 STAINLESS STEEL BODY / CORPO ACCIAIO INOSSIDABILE

DN	VALVE RATING	VALVE CODE	DESCRIPTION	VALVE PRICE (€)	KIT CODE	KIT PRICE (€)
15	ANSI 300	A6015A2S2-0001-M0000	ALFA60 DN15 ANSI300 CF8M FS RF		KGA6415A1-001	
25	ANSI 300	A6025A2S2-0001-M0000	ALFA60 DN25 ANSI300 CF8M FS RF		KGA6425A1-001	
50	ANSI 300	A6050A2S2-0001-M0000	ALFA60 DN50 ANSI300 CF8M FS RF		KGA6450A1-001	
80	ANSI 300	A6080A2S2-0001-M0000	ALFA60 DN80 ANSI300 CF8M FS RF		KGA6480A1-001	
100	ANSI 300	A60A0A2S2-0001-M0000	ALFA60 DN100 ANSI300 CF8M FS RF		KGA64A0A1-002	
150	ANSI 300	A60A5A2S2-0001-K0000	ALFA60 DN150 ANSI300 CF8M FS RF		KGA64A5A1-002	

CF8M

(\*) BARE STEM VALVE- VALVOLA A STELO NUDO



**Product codes in bold are related to product available on stock: delivery time within 3 weeks based on ordered quantity.**

All other codes are related to product ready for assembly: delivery time within 5 weeks based on ordered quantity.

Missing Sizes and Special Executions are available upon request. Please contact Sales Dept. for availability and delivery time

**I codici in grassetto indicano prodotti normalmente disponibili a stock: consegna entro 3 settimane secondo quantità ordinate**

Gli altri codici indicano prodotti disponibili per assemblaggio: consegna entro 5 settimane secondo quantità ordinate

Dimensioni mancanti ed esecuzioni speciali sono disponibili su richiesta. Si prega contattare Ufficio commerciale per disponibilità e consegne